



Nestled in Lorong Chuan (D19) and along the Circle Line, NEW TECH PARK is a B1 Hi-Tech multi-tenanted industrial building. Surrounded by greenery and flowering trees, it provides a conducive environment for its tenants. This 6 storey industrial building is an ideal hub for R&D, Electronics, Pharmaceuticals, E-commerce, Media and Technology. Just 12 mins drive away from the city, it is served by a major transport network of three expressways (CTE/PIE/KPE) and 1 min walk to Lorong Chuan MRT linking to the North South and North East MRT lines.



Accessibility

- 1 min walk to Lorong Chuan MRT
- Well connected via CTE/PIE/KPE

Building Specifications

Unit Size

- Ranges from 2,700 - 45,000 sf

Lifts

- 18 Passenger lifts (1,350 kg)
- 14 Cargo lifts (4,000 kg)
- 2 Passenger lifts (630 kg)
- 1 Lobby A Firemen lift

Unit Electrical Provision

- 63 to 200 amps 3 phase

Floor Loading

- 2nd- 6th storey (LobbyA) - 7.5kN/m²
- 2nd- 3rd storey (LobbiesB to H) - 12.5kN/m²
- 4th- 6th storey (LobbiesB to H) - 7.5kN/m²

Loading/Unloading

- 4 loading/unloading bays with dock levellers

Security

- CCTV cameras complete with digital video recorder
- Guard tour system
- 24hr security surveillance

Ceiling Height

- 1st - 6th storey ancillary office - 4.0 m
- 1st storey production - 7.0 m
- 2nd - 3rd storey production - 6.0 m
- 5th storey production - 4.0 m
- 6th storey production - 6.0 m

Car Parking

- 477 lots

Amenities Around

- Eateries & 24 hr supermarket available nearby
- New lifestyle mall with F&B options, supermarket, 24hr gym and food court
- 600+ seating capacity auditorium
- Childcare facility
- Upgraded tennis court

Signage

- Signage rights available to selected tenants, subject to payment of license fee

Typical Floor Plan

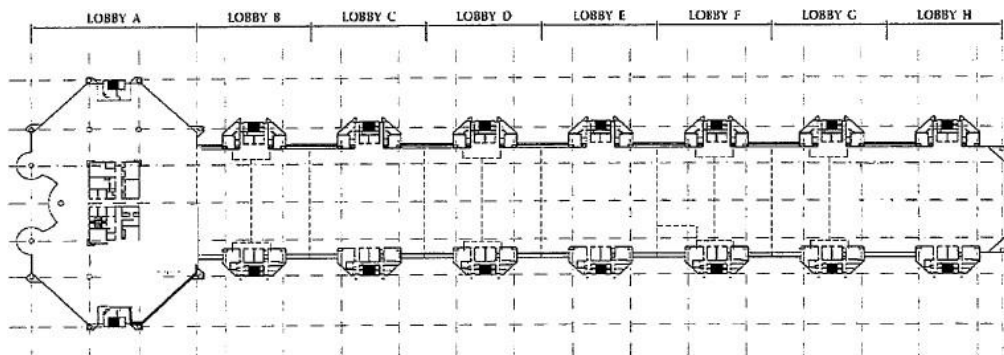

CONTACT US

+ 65 8960 6388

leasing@ai-reit.com